

Robe Hook	A14
Soap Basket	A15
Tissue Holder without cover	A16
Triple Robe Hook	A47
Spire WC roll holder	A45

Soap Basket	A13
Soap Dish	A1
Tumbler Holder	A2
Towel Ring	A3
Double Robe Hook	A4
WC Brush Holder	A8

Tools required:

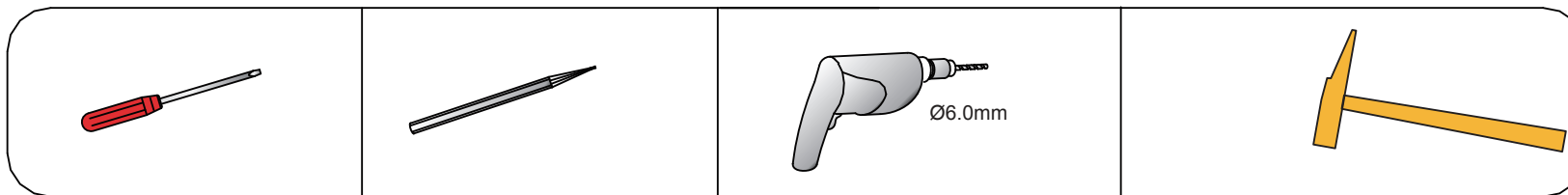

1

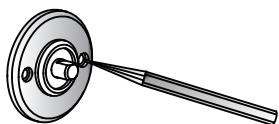

Determine the final installation position, mark the fixing hole positions in pencil.

2

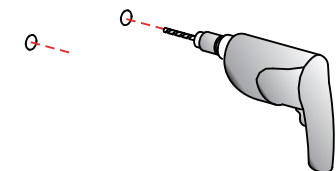

Using a 6mm drill bit, drill holes on the marked positions.

3

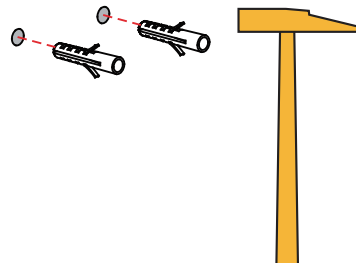

Insert the rawl plugs into the drilled holes.

4

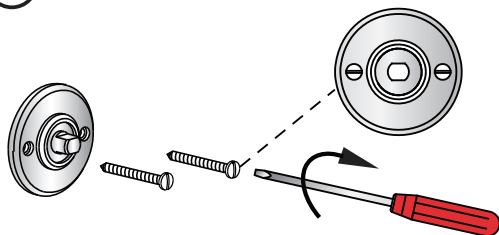

Screw in the stainless steel screws to secure the base to the wall. Please ensure that the screw heads are parallel to the floor.

5

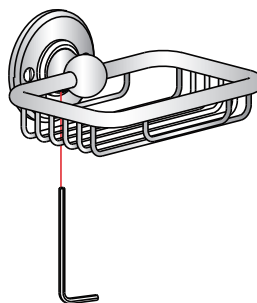

Insert the Soap Basket body into the base. Fix it with the allen key supplied.

Suggest cleaning the product surface with cleanwater or soft detergent, and then dry with soft towel.

Please do not use any detergent containing hydrochloric acid or caustic chemicals.

Avoid scratching the surface with hard objects, and do not use a coarse cloth to wipe.

The product should be installed by a professional, following the recommended installation instructions.